

AMERICAN MOTORS PARTS CATALOG

GROUP 11 SPRINGS - SHOCK ABSORBERS

DESCRIPTION	GROUP AND FIGURE NO.	GROUP NO.
ABSORBER, Front Shock	11-4, 11-5	11.200
ABSORBER, Rear Shock	11-0, 11-6	11.220
ADAPTER, Leveling Valve	11-9	11.365
BELT, Rear Air Suspension Compressor Drive	11.330
BOLT, Rear Leaf Spring Center	11-0	11.116
BRACE, Rear Air Suspension Compressor Mounting Bracket to Water Pump	11.315
BRACKET, Front Shock Absorber Upper Mounting	11-5	11.203
BRACKET, Leveling Valve Link to Rear Axle	11-7	11.382
BRACKET, Rear Air Suspension Compressor Mounting	11.310
BRACKET, Rear Air Suspension Rear Leveling Valve Mounting	11-7	11.370
BUMPER, Front Coil Spring	11-1, 11-2	11.075
CLIP KIT, Rear Leaf Spring	11-0	11.086
COMPRESSOR, Rear Air Suspension	11-7, 11-8	11.300
COVER, Rear Air Suspension Compressor Air Inlet Strainer..	11-8	11.309
CRANKSHAFT, Rear Air Suspension Compressor	11-8	11.302
CROSS, Rear Air Suspension Rear Leveling Valve	11-7	11.375
CUSHION, Front Coil Spring	11-1, 11-2	11.075
CUSHION, Rear Coil Spring	11-3	11.126
FILTER, Rear Air Suspension Air Reservoir	11-7	11.340
GASKET, Rear Air Suspension Compressor Cylinder	11-8	11.303
GROMMET, Front Shock Absorber	11-4, 11-5	11.208
GROMMET, Rear Shock Absorber	11-0, 11-6	11.228
HEAD, Rear Air Suspension Compressor Cylinder	11-8	11.303
HOSE, Rear Air Suspension Compressor to Reservoir	11-7	11.345
INSERT KIT, Rear Leaf Spring	11-0	11.084
LEAF, Rear Leaf Spring Main	11-0	11.104
LINK, Rear Air Suspension Rear Leveling Valve to Rear Axle	11-7	11.382
LUBRICANT, Rear Leaf Spring	11.080
MUFFLER, Leveling Valve Air Pressure Relief Valve	11-7	11.365
PISTON, Rear Air Suspension Air Spring	11.387
PISTON, Rear Air Suspension Compressor	11-8	11.306
PLATE, Leveling Valve Mounting Bracket to Floor Pan	11-7	11.370
PULLEY, Rear Air Suspension Compressor	11-7	11.320
PULLEY, Rear Air Suspension Compressor Drive	11.325
REED VALVE KIT, Rear Air Suspension Compressor	11-8	11.308
RESERVOIR, Rear Air Suspension Air	11-7	11.340
RETAINER, Front Shock Absorber Grommet	11-4, 11-5	11.208
RING, Rear Air Suspension Compressor Piston	11-8	11.307
ROD, Rear Air Suspension Compressor Connecting	11-8	11.305
SEAT, Front Coil Spring	11-1, 11-2	11.075
SEAT, Rear Coil Spring	11-3, 11-7	11.126
SPRING, Front Coil	11-1, 11-2	11.072
SPRING, Rear Air Suspension Air	11-7	11.385
SPRING, Rear Coil	11-3	11.102
SPRING, Rear Leaf	11-0	11.100
STRAINER, Rear Air Suspension Compressor Air Inlet	11-8	11.309
SUPPORT, Front Coil Spring	11-2	11.075
TUBE, Rear Air Suspension Air Reservoir to Rear Leveling Valve	11-7	11.360
TUBE, Rear Air Suspension Compressor Drain	11-7	11.335
TUBE, Rear Air Suspension Compressor Oil	11-7	11.335
TUBE, Rear Air Suspension Compressor to Reservoir	11-7	11.345

AMERICAN MOTORS PARTS CATALOG

DESCRIPTION	GROUP AND FIGURE NO.	GROUP NO.
TUBE, Rear Air Suspension Rear Leveling Valve to Cross	11-7	11.373
TUBE, Rear Air Suspension Rear Leveling Valve Cross to Air Spring	11-7	11.380
U-BOLT, Rear Leaf Spring to Axle	11-0	11.132
VALVE, Rear Air Suspension Air Reservoir	11-7	11.340
VALVE, Rear Air Suspension Rear Leveling	11-7, 11-9	11.365

AMERICAN MOTORS PARTS CATALOG

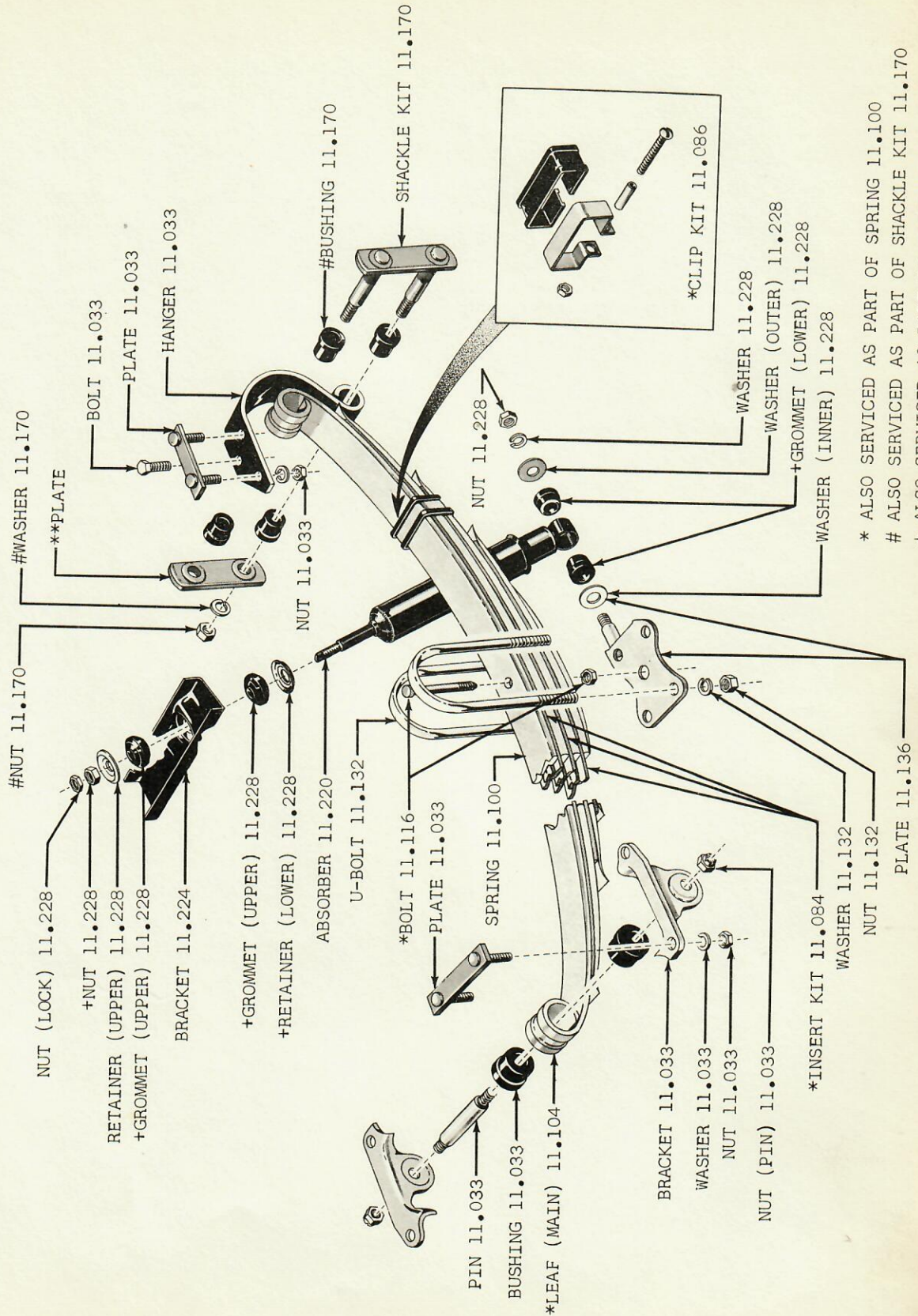

* ALSO SERVICED AS PART OF SPRING 11.100
 # ALSO SERVICED AS PART OF SHACKLE KIT 11.170
 + ALSO SERVICED AS PART OF ABSORBER 11.220
 ** SERVICED ONLY AS PART OF SHACKLE KIT 11.170

GROUP 11 - FIG. 0 - REAR LEAF SPRING AND SHOCK ABSORBER 01

AMERICAN MOTORS PARTS CATALOG

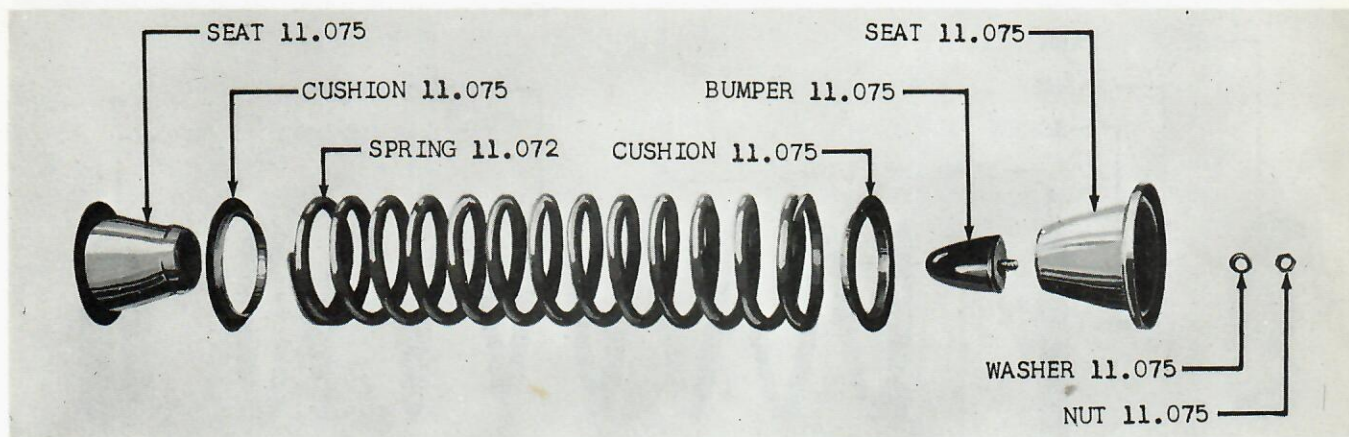

GROUP 11 - FIG. 1 - FRONT COIL SPRING 01

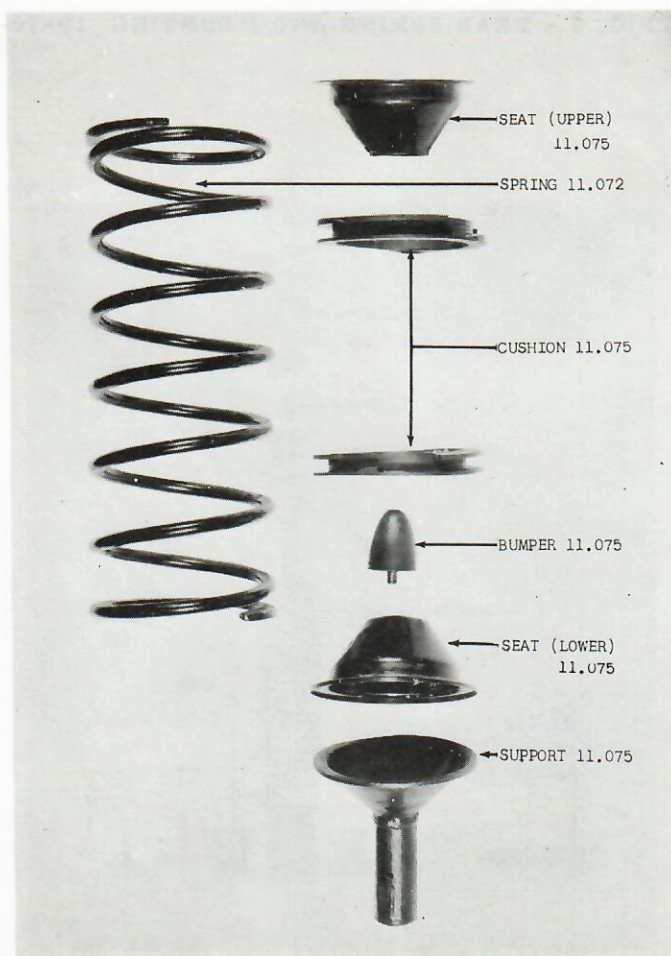

GROUP 11 - FIG. 2 - FRONT COIL SPRING AND SUPPORT 10-20-80

AMERICAN MOTORS PARTS CATALOG

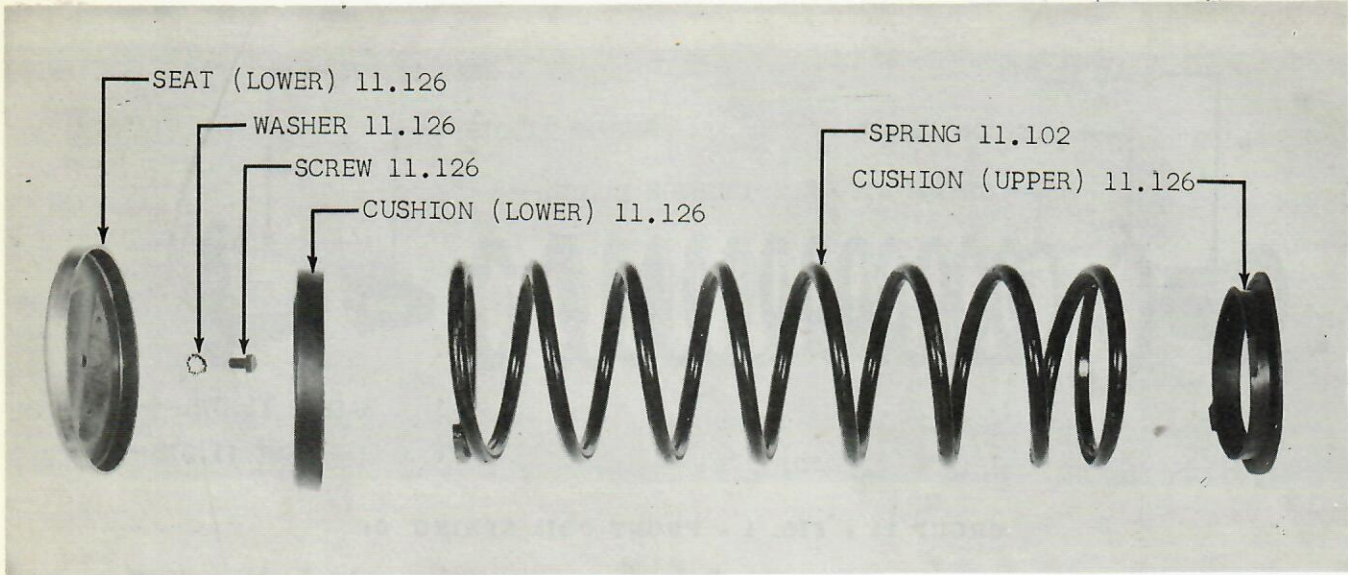

GROUP 11 - FIG. 3 - REAR SPRING AND MOUNTING 10-20-80

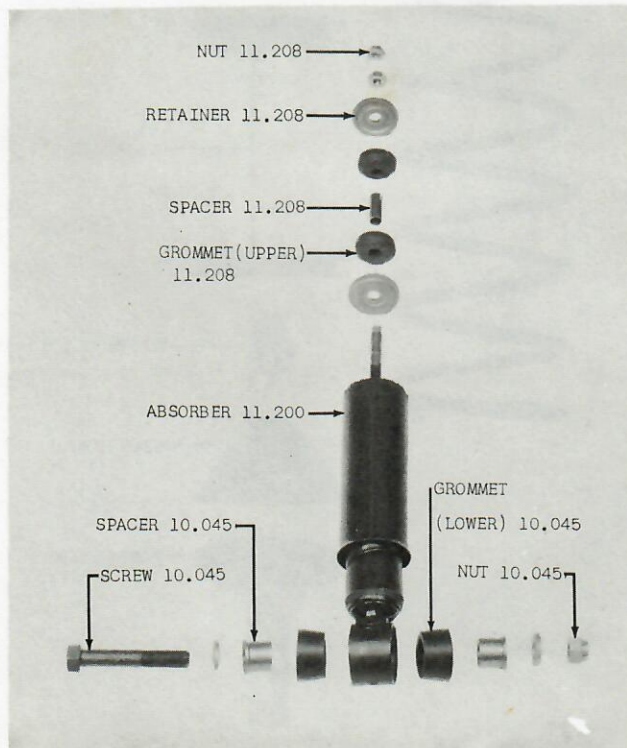

GROUP 11 - FIG. 4 - FRONT SHOCK ABSORBER MOUNTING 10-20-80

AMERICAN MOTORS PARTS CATALOG

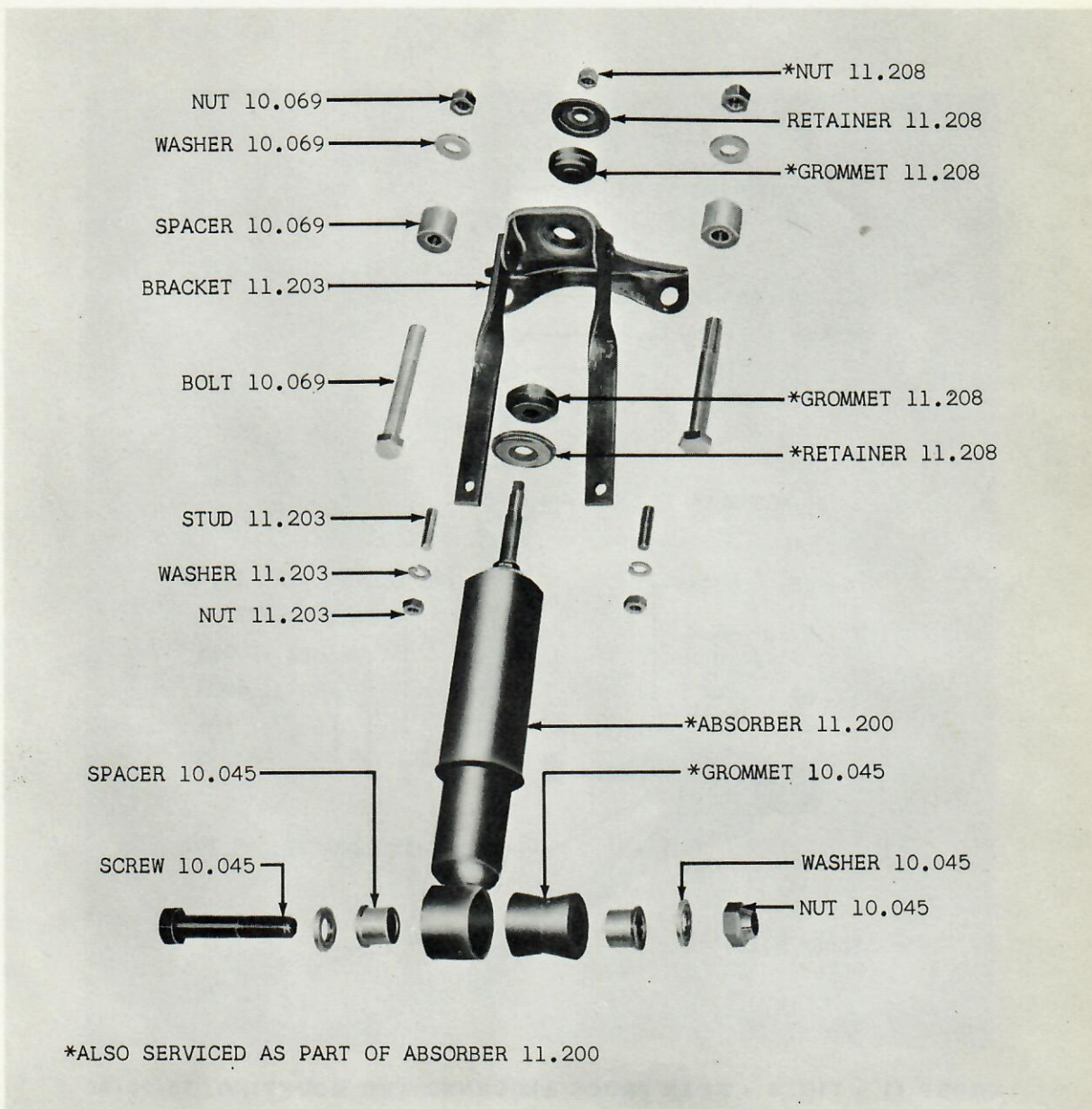

GROUP 11 - FIG. 5 - FRONT SHOCK ABSORBER AND MOUNTING 01

AMERICAN MOTORS PARTS CATALOG

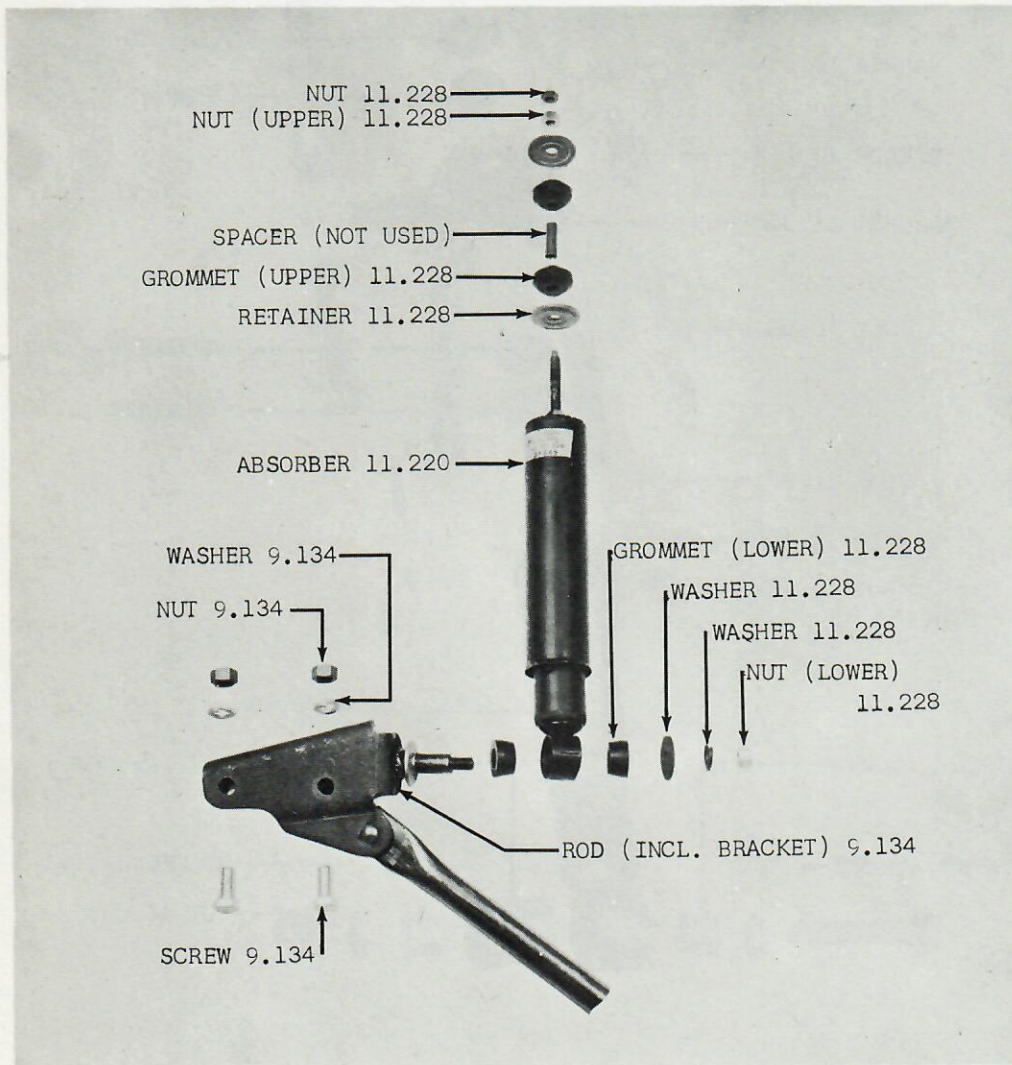

GROUP 11 - FIG. 6 - REAR SHOCK ABSORBER AND MOUNTING 10-20-80

AMERICAN MOTORS PARTS CATALOG

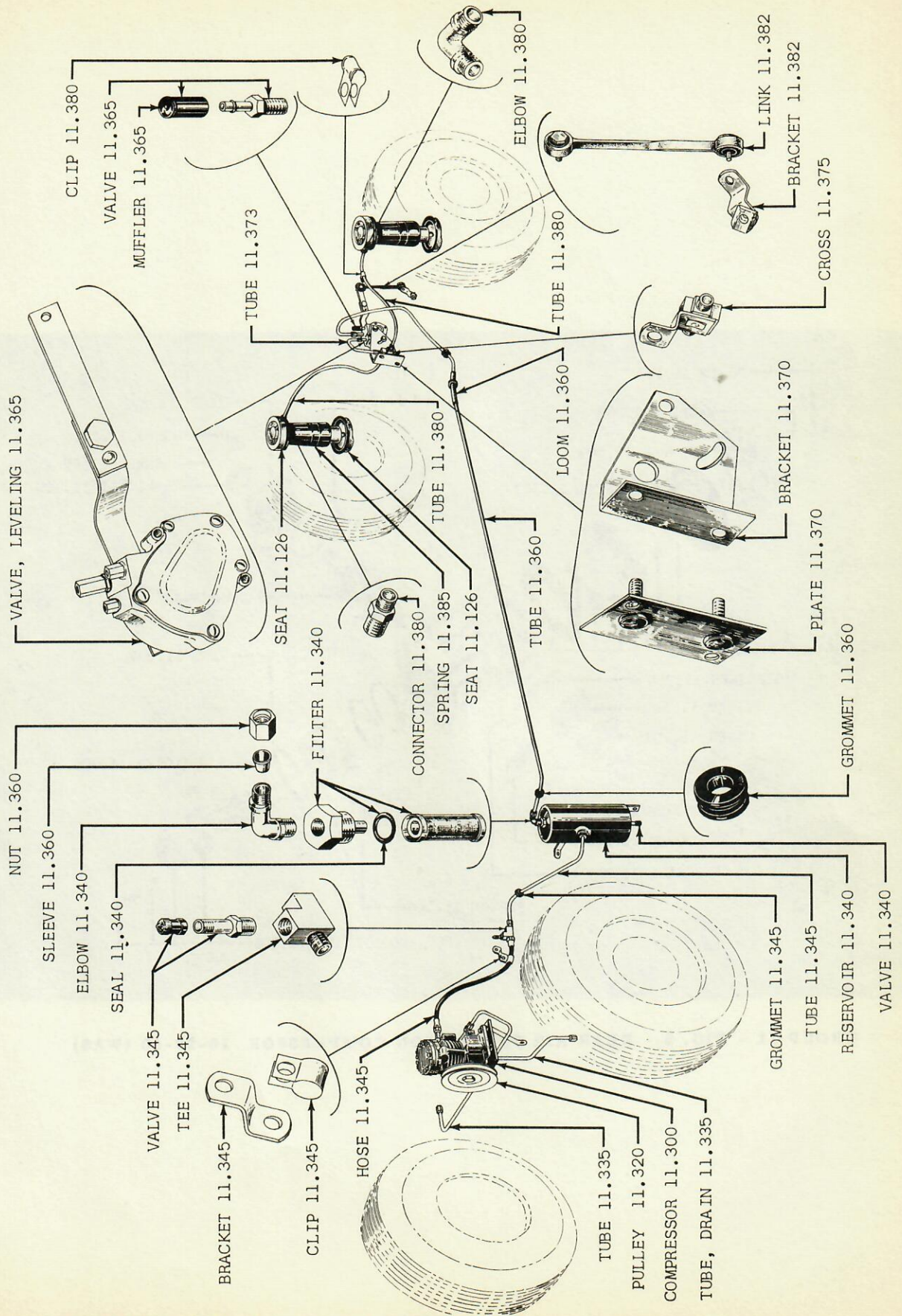

GROUP 11 - FIG. 7 - REAR AIR SUSPENSION 10-20-80 (WAS)

AMERICAN MOTORS PARTS CATALOG

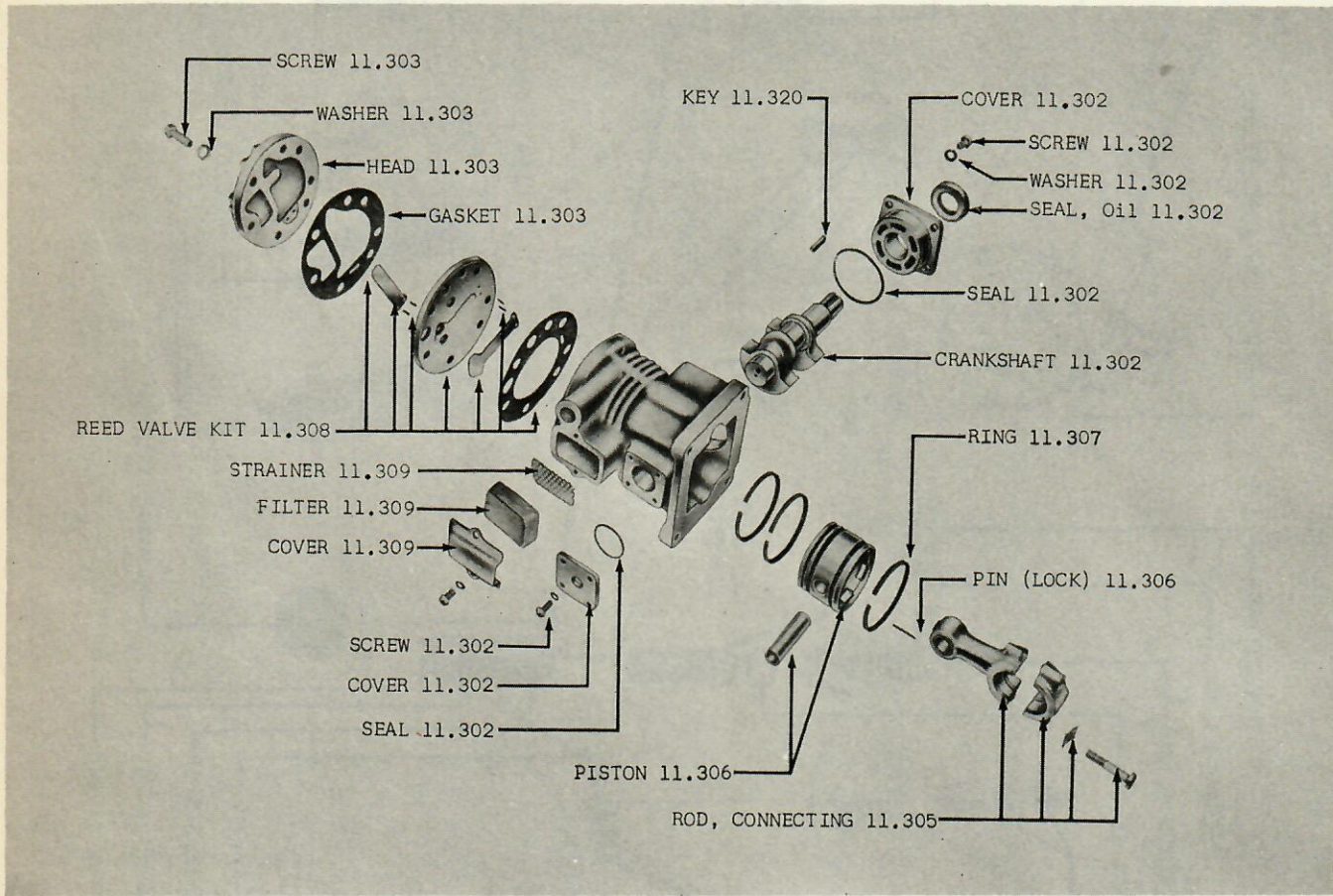

GROUP 11 - FIG. 8 - REAR AIR SUSPENSION COMPRESSOR 10-20-80 (WAS)

AMERICAN MOTORS PARTS CATALOG

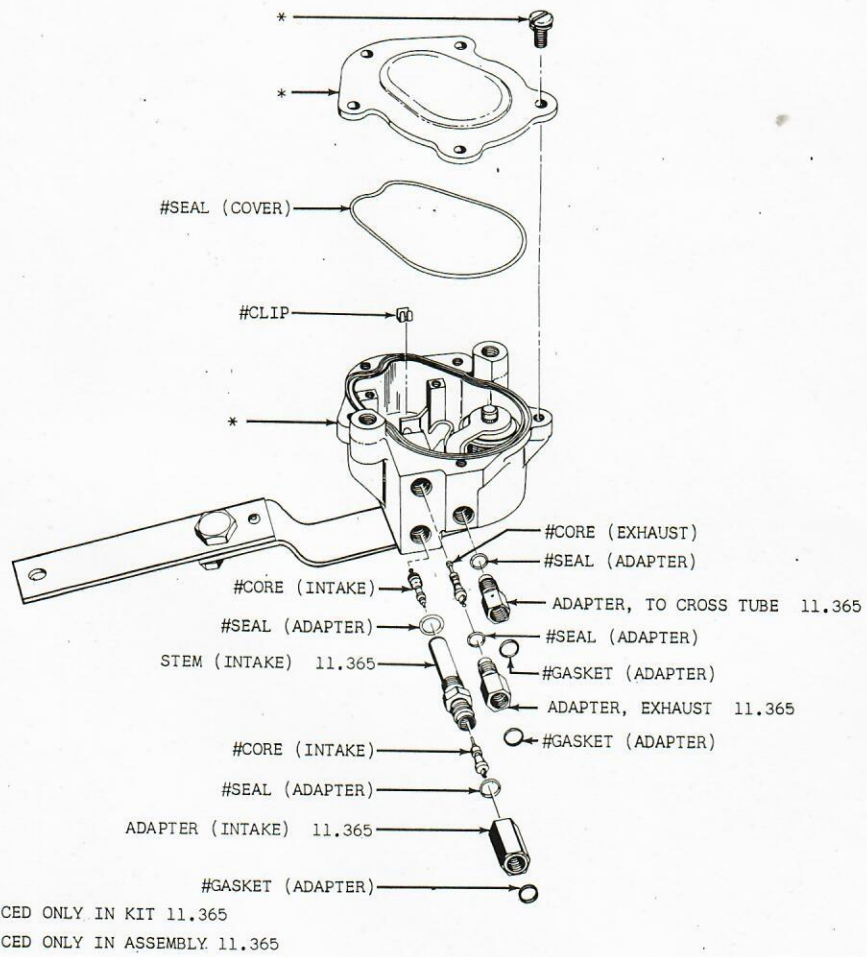

GROUP 11 - FIG. 9 - AIR SUSPENSION LEVELING VALVE 10-20-80 (WAS)

AMERICAN MOTORS PARTS CATALOG

11.075

DESCRIPTION	YEAR AND MODEL	PER CAR PART NO.
-------------	----------------	------------------

GROUP 11 SPRINGS - SHOCK ABSORBERS

11.033 BRACKET - BUSHING, Rear Leaf Spring Front Eye

BRACKET, Rear Leaf Spring Front Eye Bushing

BRACKET (To Floor Pan)(Front)(Left).....	59 01.....	2	313 0333	
(Right).....	59 01.....	2	313 0334	
HANGER, Spring To Sill (Rear)(Left).....	59 01.....	1	314 0808	
(Right).....	59 01.....	1	314 0809	
PLATE, Front Bracket To Floor Pan Mounting				
(Incl. Studs).....	59 01.....	4	340 0369	
Rear Hanger Mounting (Incl. Studs).....	59 01.....	2	340 0369	
BOLT, Hanger To Sill.....	59 01.....	2	G181637	
WASHER (Lock), Front Bracket To Mtg. Plate Stud	59 01.....	8	G120382	
Rear Hanger To Sill Bolt.....	59 01.....	6	G120382	
NUT, Front Bracket To Mounting Plate Stud.....	59 01.....	8	G120369	
Rear Hanger To Sill Bolt.....	59 01.....	6	G120369	

BUSHING, Rear Leaf Spring Front Eye

BUSHING.....	59 01.....	4	314 2071	
PIN, Bushing.....	59 01.....	2	313 0355	
NUT, Bushing Pin.....	59 01.....	4	G272712	

11.072 SPRING, Front Coil

SPRING.....	59 01 (WST)(WOD).....	2	312 9503	
	59 01 (WAT).....	2	312 9502	
	59 10 (WAC).....	2	314 7585	
	59 28 (LAC).....	2	315 0588	
	59 20 (WAC).....	2	315 0589	
	59 25-29 (LAC).....	2	315 0589	
	59 80 (LAC).....	2	315 4378	
	59 80 (WAC).....	2	315 4379	
(Left).....	59 10 (LHD-LAC).....	1	314 7585	
	59 10 (RHD-LAC).....	1	314 4874	
(Right).....	59 10 (LHD-LAC).....	1	314 4874	
	59 10 (RHD-LAC).....	1	314 7585	
(Heavy).....	59 10.....	2	315 0588	
	59 20.....	2	315 0589	
	59 80.....	2	315 4379	

11.075 SUPPORT - SEAT - CUSHION - BUMPER, Front Coil Spring

SUPPORT.....	59 10-20-80.....	2	314 4922	
SEAT (Upper).....	59 01.....	2	315 5664	
	59 10-20-80.....	2	315 2268	
(Lower).....	59 01.....	2	315 5668	
	59 10-20-80.....	2	315 2269	
GASKET, Lower Seat To Trunnion.....	59 01.....	2	314 2508	
BUMPER.....	59 01-10-20-80.....	2	312 9527	
CUSHION.....	59 01.....	4	312 9528	
	59 10-20-80.....	4	314 4895	
WASHER (Lock), Bumper To Seat.....	59 01-10-20-80.....	2	G120382	
NUT, Bumper To Seat.....	59 01-10-20-80.....	2	G120369	

11.080 LUBRICANT, Rear Leaf Spring

LUBRIPLATE (2 Oz. Tube).....	59 01.....	AR	311 3971
(1 Lb. Can)(No. 110).....	59 01.....	AR	48 304

11.084 INSERT KIT, Rear Leaf Spring

INSERT KIT (Light).....	59 01.....	2	311 8516
(Heavy).....	59 01.....	2	311 8514

11.086 CLIP KIT, Rear Leaf Spring

CLIP KIT.....	59 01.....	2	311 8535
---------------	------------	---	----------

11.100 SPRING, Rear Leaf

SPRING (Light).....	59 01.....	2	314 1138
(Heavy).....	59 01.....	2	314 2505

11.102 SPRING, Rear Coil

SPRING.....	59 15-19-25-29-85-89 (WAS).....	2	315 5786
	59 18-28-83-88 (WAS).....	2	315 5393
(Light).....	59 18-28-83-88 (LAS).....	2	314 7610
	59 15-19-25-29 (LAS).....	2	314 4929
	59 85-89 (LAS).....	2	315 4380
(Heavy).....	59 15-19-25-29-85-89 (LAS).....	2	314 7610
	59 18-28-83-88 (LAS).....	2	314 9125
(Extra Heavy).....	59 15-19-25-29-85-89 (LAS).....	2	314 9125

11.104 LEAF, Rear Leaf Spring Main

LEAF.....	59 01.....	2	311 8512
-----------	------------	---	----------

11.116 BOLT, Rear Leaf Spring Center

BOLT (Incl. Nut).....	59 01.....	2	311 8517
-----------------------	------------	---	----------

11.126 SEAT - CUSHION, Rear Coil Spring

SEAT (Lower).....	59 10-20-80.....	2	315 5359
(Upper)(Less Connector, Sleeve And Nut)...	59 18-28-83-88 (WAS).....	2	315 5410
(Less Elbow, Sleeve And Nut).....	59 15-19-25-29-85-89 (WAS).....	2	315 5411
CUSHION (Lower).....	59 10-20-80.....	2	314 5218
(Upper).....	59 10-20-80.....	2	314 5103
(For Air Spring).....	59 10-20-80 (WAS).....	2	315 5400
BOLT, Lower Seat To Axle Tube.....	59 10-20-80 (LAS).....	2	G181627
WASHER (Lock), Lower Seat To Axle Tube Bolt....	59 10-20-80 (LAS).....	2	G120382

11.132 U-BOLT, Rear Leaf Spring To Axle

U-BOLT (With 5 Leaf Light Spring).....	59 01.....	4	313 9294
(With 6 Leaf Heavy Spring).....	59 01.....	4	313 1033
WASHER (Lock), U-Bolt.....	59 01.....	8	G103323
NUT, U-Bolt.....	59 01.....	8	800 0251

AMERICAN MOTORS PARTS CATALOG

11.220

11.136 PLATE, Rear Leaf Spring To Axle U-Bolt Tie

PLATE (Rear Shock Absorber Lower Mtg. (Left)...	59 01.....		1	313 5013
(Right)...	59 01.....		1	313 5014

11.170 SHACKLE KIT, Rear Leaf Spring

SHACKLE KIT (Incl. Shackle And Bolt, Plate, Bushings, Washers And Nuts).....	59 01.....		2	311 7391
BUSHING, Shackle.....	59 01.....		8	312 9665
WASHER (Lock), Shackle Bolt.....	59 01.....		4	G103321
NUT, Shackle Bolt.....	59 01.....		4	G120369

11.200 ABSORBER, Front Shock

ABSORBER.....	59 01.....		2	320 0842
	59 10-20-80 (LAS)(Note 10.045-1 Type 1).....		2	311 9821
	59 10-20-80 (LAS)(Note 10.045-1 Type 2).....		2	320 0857
	59 10-20-80 (WAS).....		2	320 0980

11.203 BRACKET, Front Shock Absorber Upper Mounting

BRACKET.....	59 01.....		2	313 5344
STUD, Bracket Brace To Sill.....	59 01.....		4	313 6091
WASHER (Lock), Bracket Brace To Sill Stud.....	59 01.....		4	G120214
NUT, Bracket Brace To Sill Stud.....	59 01.....		4	G120368

11.208 GROMMET, Front Shock Absorber

GROMMET (Upper).....	59 01-10-20-80.....		4	312 7384
(Lower).....	59 01: 59 10-20-80 (Note 10.045-1 Type 1)....		4	313 3578
	59 10-20-80 (Note 10.045-1 Type 2).....		4	95 205
RETAINER, Upper Grommet (Upper).....	59 01-10-20-80.....		2	313 6432
(Lower).....	59 01-10-20-80.....		2	314 6809
SPACER, Grommet (Lower).....	59 01: 59 10-20-80 (Note 10.045-1 Type 1)....		4	315 0290
BOLT, Shock Absorber Mounting.....	59 01: 59 10-20 (Note 10.045-1 Type 1).....		2	315 0285
	59 80 (Note 10.045-1 Type 1).....		2	315 3049
	59 10-20-80 (Note 10.045-1 Type 2).....		2	G181670
WASHER (Plain), Shock Absorber Mounting Bolt (Lower).....	59 01: 59 10-20-80 (Note 10.045-1 Type 1)....		4	311 7621
(Lock), Shock Absorber Mounting Bolt (Lower).....	59 10-20-80 (Note 10.045-1 Type 2).....		2	G103328
NUT, Shock Absorber Mounting Bolt (Lower).....	59 01: 59 10-20 (Note 10.045-1 Type 1).....		2	G442834
	59 80 (Note 10.045-1 Type 1).....		2	G124634
	59 10-20-80 (Note 10.045-1 Type 2).....		2	G103027
(Upper).....	59 01-10-20-80.....		2	G124925
Lock (Upper).....	59 01-10-20-80.....		2	G120369

11.220 ABSORBER, Rear Shock

ABSORBER.....	59 01.....		2	320 0843
	59 10-20-80 (LAS).....		2	311 9822
	59 15-19-25-29-85-89 (WAS).....		2	320 0981
	59 18-28-83-88 (WAS).....		2	320 0982

AMERICAN MOTORS PARTS CATALOG

11.224 BRACKET, Rear Shock Absorber Upper Mounting

BRACKET (Left).....	59 01.....	1	437 0145
(Right).....	59 01.....	1	437 0146

11.228 GROMMET, Rear Shock Absorber

GROMMET (Upper).....	59 01-10-20-80.....	4	312 7384
(Lower).....	59 01-10-20-80.....	4	95 205
RETAINER, Upper Grommet (Upper).....	59 01-10-20-80.....	2	313 6432
(Lower).....	59 01-10-20-80.....	2	314 6809
WASHER (Plain), Shock Absorber Mounting			
(Lower)(Outer).....	59 01-10-20-80.....	2	313 5017
Shock Absorber Mounting			
(Lower)(Inner).....	59 01.....	2	313 5016
(Lock), Shock Absorber Mounting (Lower)	59 01-10-20-80.....	2	311 8257
NUT, Shock Absorber Mounting (Lower).....	59 01-10-20-80.....	2	311 7755
Shock Absorber Mounting (Upper).....	59 01-10-20-80.....	2	G120369
Lock (Upper).....	59 01-10-20-80.....	2	G124925

11.300 COMPRESSOR, Rear Air Suspension

COMPRESSOR.....	59 10-20-80.....	1	315 6563
VALVE, Air Check.....	59 10-20-80.....	1	315 5622
PLATE, Compressor Base.....	59 10-20-80.....	1	315 5391
GASKET, Compressor Base Plate.....	59 10-20-80.....	1	315 5372
STUD, Base Plate To Compressor.....	59 10-20-80.....	4	315 5368
WASHER (Plain), Compressor To Mtg. Bracket Stud	59 10.....	4	G120393
(Lock), Base Plate To Compressor Stud...	59 10-20-80.....	4	G120214
Compressor To Mtg. Bracket Stud.	59 10-20-80.....	4	G120214
NUT, Compressor To Mounting Bracket Stud.....	59 10-20-80.....	4	G120368

11.302 CRANKSHAFT, Rear Air Suspension Compressor

CRANKSHAFT.....	59 10-20-80.....	1	320 1084
COVER (Rear).....	59 10-20-80.....	1	320 1094
(Front).....	59 10-20-80.....	1	320 1089
SEAL, Crankshaft Oil.....	59 10-20-80.....	1	320 1090
SEAL, Cover ("O" Ring)(Front).....	59 10-20-80.....	1	320 1087
(Rear).....	59 10-20-80.....	1	320 1091
SCREW, Cover (Front).....	59 10-20-80.....	4	G180018
(Rear).....	59 10-20-80.....	6	G423594
WASHER (Lock), Front Cover Screw.....	59 10-20-80.....	4	G113114

11.303 HEAD - GASKET, Rear Air Suspension Compressor Cylinder

HEAD.....	59 10-20-80.....	1	320 1114
GASKET.....	59 10-20-80.....	1	320 1113
SCREW, Cylinder Head.....	59 10-20-80.....	7	G180081
WASHER (Lock), Cylinder Head Screw.....	59 10-20-80.....	7	G120214

11.305 ROD, Rear Air Suspension Compressor Connecting

ROD (Incl. Bushing, Bearing, Cap And Bolts)....	59 10-20-80.....	1	320 1095
BOLT, Connecting Rod.....	59 10-20-80.....	2	320 1096
WASHER (Lock), Connecting Rod Bolt.....	59 10-20-80.....	2	320 1097

AMERICAN MOTORS PARTS CATALOG

11.320

11.306 PISTON, Rear Air Suspension Compressor

PISTON (Incl. Pin).....	59 10-20-80.....	1 320 1198
PIN (Lock), Piston Pin.....	59 10-20-80.....	1 320 1106

11.307 RING, Rear Air Suspension Compressor Piston

RING.....	59 10-20-80.....	3 320 1197
-----------	------------------	------------

11.308 REED VALVE KIT, Rear Air Suspension Compressor

REED VALVE KIT (Incl. Pin, Reeds, Plate And Cylinder Head Gasket).....	59 10-20-80.....	1 320 1115
GASKET, Valve Plate.....	59 10-20-80.....	1 320 1441

11.309 STRAINER - COVER, Rear Air Suspension Compressor Air Inlet

STRAINER.....	59 10-20-80.....	1 320 1116
COVER, Strainer.....	59 10-20-80.....	1 320 1119
FILTER, Air Inlet (Inner).....	59 10-20-80.....	1 320 1117
(Outer).....	59 10-20-80.....	1 320 1118

11.310 BRACKET, Rear Air Suspension Compressor Mounting

BRACKET.....	59 10.....	1 315 5405
	59 20-80.....	1 315 5445
STUD, Bracket And Thermostat Housing To Cylinder Head.....	59 10.....	1 315 5368
Bracket And Battery Ground Strap To Cylinder Head.....	59 10.....	1 315 5365
BOLT, Bracket To Cylinder Head.....	59 10.....	1 315 5367
	59 20-80.....	3 G180121
Water Manifold.....	59 20-80.....	1 G179842
SPACER, Bracket To Cylinder Head Bolt.....	59 10.....	1 315 5366
WASHER (Lock), Bracket And Thermostat Housing To Cylinder Head Stud.....	59 10.....	2 G120214
Bracket To Cylinder Head.....	59 20-80.....	3 G138489
NUT, Bracket And Thermostat Housing To Cylinder Head Stud.....	59 10.....	1 G120368

11.315 BRACE, Rear Air Suspension Compressor Mounting Bracket To Water Pump

BRACE.....	59 10.....	1 315 5390
	59 10 (Heavy Duty Generator).....	1 315 5652
BOLT, Brace To Bracket.....	59 10.....	1 G181595
Water Pump.....	59 10 (Heavy Duty Generator).....	1 G179840
WASHER (Plain), Brace To Water Pump Bolt.....	59 10 (Heavy Duty Generator).....	1 800 0165
(Lock), Brace To Bracket.....	59 10.....	1 G120214
NUT, Brace To Bracket Bolt.....	59 10.....	1 G120368

11.320 PULLEY, Rear Air Suspension Compressor

PULLEY.....	59 10-20-80.....	1 315 5407
SPACER, Pulley.....	59 20-80.....	1 315 5538
KEY, Pulley.....	59 10-20-80.....	1 320 1120

BOLT, Pulley.....	59 10-20-80.....	1	800 0311
WASHER (Plain), Pulley Bolt.....	59 10-20-80.....	1	314 1080
(Lock), Pulley Bolt.....	59 10-20-80.....	1	G120214

11.325 PULLEY, Rear Air Suspension Compressor Drive

PULLEY.....	59 10.....	1	315 5389
	59 20-80.....	1	315 5387
SCREW, Pulley.....	59 20-80 (WPS).....	3	G181593
WASHER (Lock), Pulley Screw.....	59 20-80 (WPS).....	3	G138485

11.330 BELT, Rear Air Suspension Compressor Drive

BELT.....	59 10.....	1	314 4018
	59 20-80.....	1	315 0219

11.335 TUBE, Rear Air Suspension Compressor Oil

TUBE, Crankcase To Comp. Oil Feed (Pressure)...	59 10.....	1	315 5403
	59 20-80.....	1	315 5406
Compressor To Block Drain.....	59 10.....	1	315 5404
	59 20-80.....	1	315 5537
CONNECTOR, Oil Drain Tube (In Compressor And Cylinder Block)...	59 10.....	2	G137406
(In Compressor).....	59 20-80.....	1	G137406
ELBOW, Oil Feed Tube (In Manifold).....	59 10.....	1	G137421
(In Cylinder Block).....	59 20-80.....	1	G137421
(In Compressor).....	59 10-20-80.....	1	315 3879
Oil Drain Tube (In Cylinder Block).....	59 10.....	1	G137422
Drain Tube (In Timing Case Cover).....	59 20-80.....	1	G137422
REDUCER, Oil Feed Tube Elbow (In Cyl. Block)...	59 20-80.....	1	315 5369

11.340 RESERVOIR, Rear Air Suspension Air

RESERVOIR.....	59 10-20-80.....	1	315 5413
VALVE, Emergency.....	59 10-20-80.....	1	315 5383
FILTER, Reservoir (Incl. Adapter).....	59 10-20-80.....	1	315 5378
SEAL, Reservoir Filter ("O" Ring).....	59 10-20-80.....	1	313 7267
ELBOW, Reservoir Air Outlet (At Filter End)....	59 10-20-80.....	1	315 5358
SCREW, Reservoir Mounting.....	59 10-20-80.....	2	800 0103
WASHER (Plain), Reservoir Mounting Screw.....	59 10-20-80.....	2	800 0143
GROMMET, Reservoir Mounting Screw.....	59 10-20-80.....	2	315 6248

11.345 HOSE - TUBE, Rear Air Suspension Compressor To Reservoir

HOSE, To Tee (Flexible)(18-1/2" Long).....	59 10-20-80.....	1	315 5907
TUBE (Metal).....	59 10-20.....	1	315 5688
	59 80.....	1	315 5689
VALVE, Emergency Air (Between Hose And Tube)...	59 10-20-80.....	1	315 5383
TEE, Hose To Tube (For Air Valve).....	59 10-20-80.....	1	315 5921
INSULATOR, Tube.....	59 10-20-80.....	1	315 5687
CLIP, Hose (At Bracket).....	59 10-20-80.....	1	314 6527
Tube (At Wheelhouse).....	59 10-20-80.....	1	96 823
BRACKET, Hose Clip.....	59 10-20-80.....	1	315 5615
GROMMET, Hose Clip Bracket To Wheelhouse Screw.	59 10-20-80.....	1	315 5374
(At Wheelhouse).....	59 10-20-80.....	1	315 5665

AMERICAN MOTORS PARTS CATALOG

11.375

SLEEVE, Hose Clip Bracket To Wheelhouse			
Screw Grommet.....	59 10-20-80.....	1	315 5373
SCREW, Hose Clip Bracket To Wheelhouse.....	59 10-20-80.....	1	G172431
To Bracket.....	59 10-20-80.....	1	G1784 34
WASHER (Plain), Hose Clip Bracket To			
Wheelhouse Screw.....	59 10-20-80.....	1	G120392

11.360 TUBE, Rear Air Suspension Air Reservoir To Rear Leveling Valve

TUBE.....	59 10-20-80.....	1	315 5425
CONNECTOR, Tube To Intake Valve.....	59 10-20-80.....	1	315 5491
SLEEVE, Tube.....	59 10-20-80.....	2	315 5356
NUT, Tube.....	59 10-20-80.....	2	315 5357
LOOM, Tube (Used on Rear Seat Riser).....	59 10-20-80.....	1	313 2372
GROMMET, Tube (On Left Cowl Panel And Left			
Rear Floor Pan).....	59 10-20-80.....	2	310 5702
CLAMP, Tube (On Leveling Valve Bracket).....	59 10-20-80.....	1	313 0379

11.365 VALVE, Rear Air Suspension Rear Leveling

VALVE (Less Relief Valve And Connector).....	59 10-20-80.....	1	315 5492
Air Pressure Relief (In Valve)			
(Incl. Muffler).....	59 10-20-80.....	1	315 5776
MUFFLER, Air Pressure Relief Valve.....	59 10-20-80.....	1	315 5774
CONNECTOR, Tube To Intake Valve.....	59 10-20-80.....	1	315 5491
ADAPTER (Exhaust Valve).....	59 10-20-80.....	1	320 1140
(To Cross Tube).....	59 10-20-80.....	1	320 1139
(Air Intake Valve).....	59 10-20-80.....	1	320 1138
STEM, Air Intake Valve.....	59 10-20-80.....	1	320 1137
CORE, Seal And Gasket Kit, Valve.....	59 10-20-80.....	1	320 1247

11.370 BRACKET, Rear Air Suspension Rear Leveling Valve Mounting

BRACKET.....	59 10-20-80.....	1	315 5488
PLATE, Bracket To Floor Pan (Incl. Weld Bolts).	59 10-20-80.....	1	343 1142
BOLT, Valve To Bracket.....	59 10-20-80.....	2	G181595
Bracket To Floor Pan.....	59 10-20-80.....	2	G445615
SCREW, Plate To Floor Pan.....	59 10-20-80.....	2	G161860
WASHER (Plain), Valve To Bracket Bolt.....	59 10-20-80.....	1	G120393
Bracket To Floor Pan.....	59 10-20-80.....	2	G120393
(Lock), Valve To Bracket Bolt.....	59 10-20-80.....	2	G120214
Bracket To Floor Pan Bolt.....	59 10-20-80.....	2	G120214
NUT, Bracket To Floor Pan Bolt.....	59 10-20-80.....	2	G120368

11.373 TUBE, Rear Air Suspension Rear Leveling Valve To Cross

TUBE.....	59 10-20-80.....	1	315 5540
-----------	------------------	---	----------

11.375 CROSS, Rear Air Suspension Rear Leveling Valve

CROSS.....	59 10-20-80.....	1	315 5487
VALVE, Air Gauge Check (In Cross).....	59 10-20-80.....	1	315 5383

AMERICAN MOTORS PARTS CATALOG

11.380 TUBE, Rear Air Suspension Rear Leveling Valve Cross To Air Spring

TUBE (Left).....	59 10-20-80.....	1	315 5426
(Right).....	59 10-20-80.....	1	315 5427
ELBOW, Tube (In Upper Spring Seat)(Left).....	59 10-20-80.....	1	315 5358
CONNECTOR, Tube (In Upper Spring Seat)(Right)..	59 10-20-80.....	1	315 5355
SLEEVE, Tube.....	59 10-20-80.....	4	315 5356
NUT, Tube.....	59 10-20-80.....	4	315 5357
CLIP, Tube.....	59 10-20-80.....	1	15 898
SCREW, Tube Clip.....	59 10-20-80.....	1	800 0091

11.382 LINK, Rear Air Suspension Rear Leveling Valve To Rear Axle

LINK.....	59 10-20-80.....	1	315 5489
BRACKET, Link To Axle Housing Cover.....	59 18-28-83-88.....	1	315 5539
	59 15-19-25-29-85-89.....	1	315 5437
WASHER, Link To Leveling Valve Arm And Rear Axle Housing Cover.....	59 10-20-80.....	2	G120392
NUT, Link To Leveling Valve Arm And Rear Axle Housing Cover.....	59 10-20-80.....	2	G120367

11.385 SPRING, Rear Air Suspension Air

SPRING (Rubber).....	59 10-20-80.....	2	315 5409
----------------------	------------------	---	----------

11.387 PISTON, Rear Air Suspension Air Spring

PISTON.....	59 10-20-80.....	2	315 5523
STUD, Piston To Axle Tube.....	59 10-20-80.....	2	315 5360